



- MODERN VICTORIAN TERRACE HOUSE
- POPULAR BROADWATER LOCATION
- 3 DOUBLE BEDS, 3 RECEPTIONS
- 6 MONTH LET
- SOME CHARACTER FEATURES, GFCH
- AVAILABLE TO LET IN SEPTEMBER



94 Westcourt Road
Worthing BN14 7DP

Monthly Rental Of
£1,750

A great opportunity to let this modern Victorian terrace house situated in the popular location of Broadwater, close to schools, local amenities and Worthing train station. Accommodation to the ground floor comprises Entrance porch, entrance hall, 15ft lounge, 12ft1 dining room, 11ft2 breakfast room and modern fitted kitchen. To the first floor are three good size double bedrooms, modern family bathroom and separate WC. Other benefits include part double glazing, some retained character features and gas fired central heating. Externally is a low maintenance front garden and secluded rear garden with original tiling. The property will be available for a 6 month let from September and is part furnished.

Entrance porch

Single glazed front door to entrance porch. Door to:

Entrance hall

With radiator, laminate flooring, picture rail, under stairs cupboard.

Lounge 15' 0" x 11' 7" (4.57m x 3.53m)

Double glazed bay window to front aspect, electric fireplace, laminate flooring, picture rail, feature cornice, radiator.

Dining room 12' 1" x 9' 4" (3.68m x 2.84m)

Single glazed sash window to rear aspect, radiator, laminate flooring, picture rail, original fire place.

Kitchen/Breakfast Room 22' 5" x 10' 5" (6.83m x 3.17m)

Kitchen area: Range of fitted wall and base units, roll edged work surfaces, one and half bowl stainless steel sink, single glazed sash window, space for washing machine, oven and fridge freezer, stone tiled flooring, door to rear garden. Breakfast area: Radiator, Single glazed sash window overlooking garden, cupboard, picture rail.

Stairs rising to first floor landing

Loft hatch with pull down ladder to loft space with light.

Bedroom one 15' 0" x 12' 1" (4.57m x 3.68m)

Double glazed bay window to front aspect, picture rail, radiator, carpet, built in wardrobes.

Bedroom two 12' 1" x 9' 4" (3.68m x 2.84m)

Single glazed sash window, radiator, fireplace, picture rail.

Bedroom three 13' 1" x 10' 3" (3.98m x 3.12m)

Single glazed sash window, radiator, fireplace, carpet, picture rail.

Bathroom

Modern bathroom suite comprising bath with shower connector, single glazed sash window, pedestal wash basin, tiled flooring, tiled walls, wall heater.

Separate WC

WC, laminate flooring, tiled walls, single glazed window.

Outside

Front - low maintenance front garden Rear - Mainly laid to lawn with original tiling and rear access.

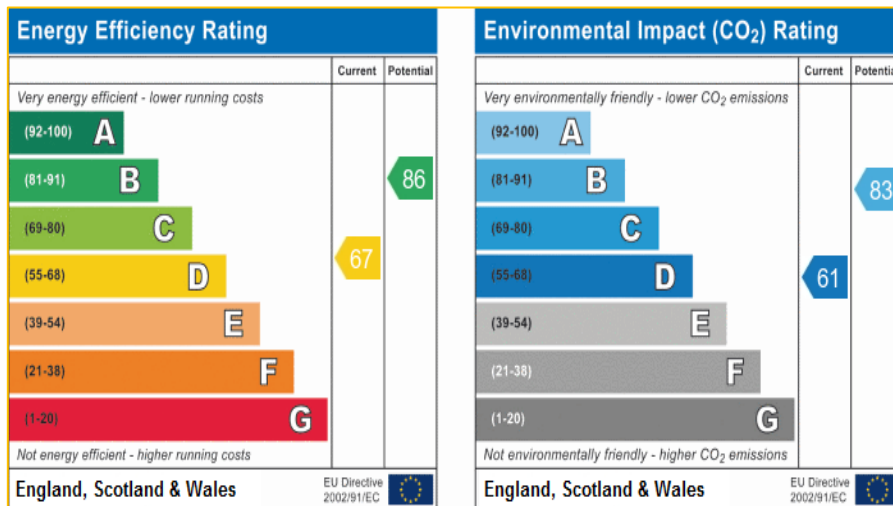

traditional values modern thinking

Ground floor



floor planner

First floor

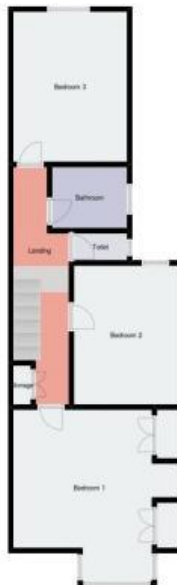

floor planner

traditional values modern thinking